

**PHILIPS**

**EasyKey**

5000 series

Smart rim lock

DDL505-5HBS

# User manual

[www.philips.com/support](http://www.philips.com/support)

Sign your product up and get support at  
[www.philips.com/support](http://www.philips.com/support)





# Contents

---

<b>1. Important Information</b>	02	<b>5. Get to use your lock</b>	11
Safety		Outdoor/ indoor unlock	
Caution			
Disposal of used products and batteries			
<hr/>			
<b>2. Assembly</b>	03	<b>6. Other features</b>	12
Packing list		Default settings	
Exploded views		Mute button	
Notice before assembling		Armed mode	
Assembly procedures			
<hr/>			
<b>3. Get to know your lock</b>	07	<b>7. Indicators</b>	14
Exterior assembly		Low battery indicator	
Interior assembly		Armed mode indicator	
		System locking indicator	
<hr/>			
<b>4. Settings</b>	08	<b>8. Troubleshooting</b>	15
Instructions before setting		Alert types	
Master mode		How to apply external power supply	
Add user information		Battery replacement	
System settings			
<hr/>			

---

# 1 Important information

---

## Safety

- ◆ Before using this product, please read and understand all instructions. Damage caused by failure to follow the instructions is not covered by the warranty.
- ◆ Use only the accessories/components specified by the manufacturer.
- ◆ Use only the alkaline batteries with which the product is equipped or use alkaline batteries of the same type.
- ◆ Do not forcibly disassemble the product to trigger an alarm or damage the product.
- ◆ Do not scrape the fingerprint sensor with sharp objects, as this may cause permanent damage.
- ◆ Do not expose products to places that have water leakage or splashing.
- ◆ Do not expose the product to corrosive substances to prevent damaging the protective cover.
- ◆ Do not hang objects on the handle in case it might affect the use of the lock.
- ◆ Please use a soft cloth soaked in water to remove fingerprints/dirt left on the surface of the assembly.
- ◆ Do not remove the batteries during setting up and operating.
- ◆ Please follow the assembly instructions to install the product and keep the relevant sealed stickers properly.
- ◆ Please change the default master PIN code immediately after completing the installation and troubleshooting, properly store the mechanical keys, and do not disclose the PIN codes to others.
- ◆ Please replace all batteries immediately when a low battery alarm appears.

## Caution

- ◆ Do not place the batteries near ignition source to avoid explosion.
- ◆ Do not use any power supply that does not meet the safety requirements to power up the product.
- ◆ Do not connect the 2 poles of the batteries to metals to avoid a short circuit that may cause an explosion.
- ◆ Please make sure installation or any component replacement is performed by Philips, a Philips authorized service center or professional technicians.
- ◆ Do not use accessories or parts manufactured by others or not expressly recommended by Philips. The use of such accessories and parts may void the warranty.

## Disposal of used products and batteries

- ◆ You can have your locks taken back at authorized Philips service centers. You will receive appropriate compensation if your products meet our conditions.
- ◆ Please familiarize yourself with the local collection system for electronic products.
- ◆ Please follow local regulations and do not discard used products and batteries into ordinary household waste.
- ◆ Please familiarize yourself with the local regulations for recycling batteries. Proper disposal of batteries can help prevent negative effects on the environment and human health.

# 2 Assembly

## Packing list

This packing list is for reference only. Please refer to the actual packing items.

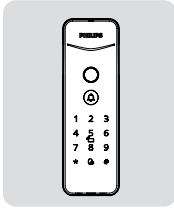

① Exterior assembly with silicon pad

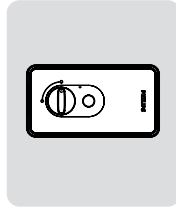

② Interior assembly with silicon pad

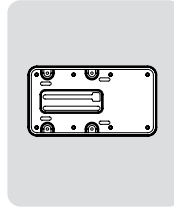

③ Mounting plate

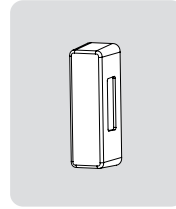

④ Strike cover

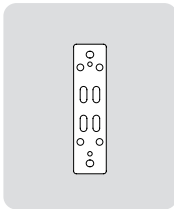

⑤ Strike plate (2mm thick)

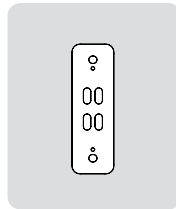

⑥ Metal strike shim (2mm thick)

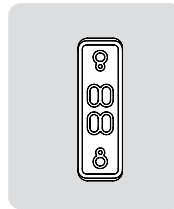

⑦ Plastic strike shim (3mm thick)

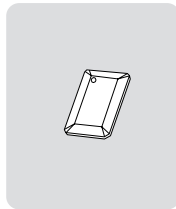

⑧ Key tag



⑨ Warranty card



⑩ Quick start guide

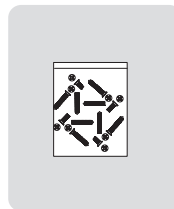

⑪ Installation kit

## Exploded views

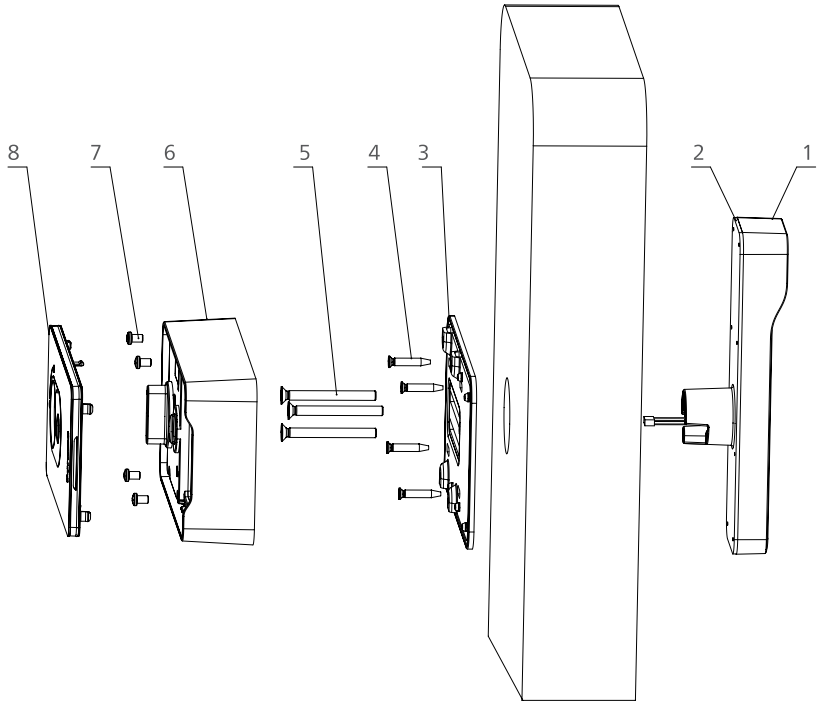

- 1. Exterior assembly x1
- 2. Silicone pad for exterior assembly x1
- 3. Mounting plate x1
- 4. Fixing screws for exterior assembly x4
- 5. M5 flathead screw x3
- 6. Interior assembly x1
- 7. Fixing screws for interior assembly x4
- 8. Battery cover x1

# Notice before assembling

## Step 1 | Door swing direction

This product applies to doors with swing directions as follows: left-hand inswing, left-hand outswing, right-hand inswing, and right-hand outswing.

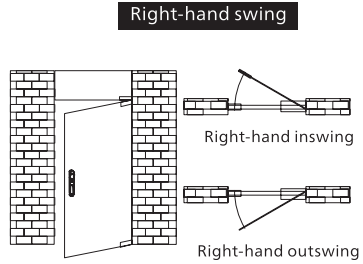
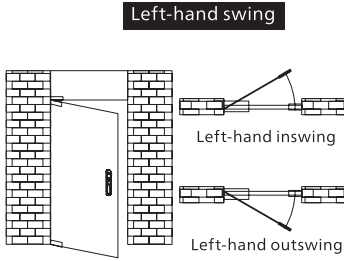

## Step 2 | Illustrations for doors with different swing directions

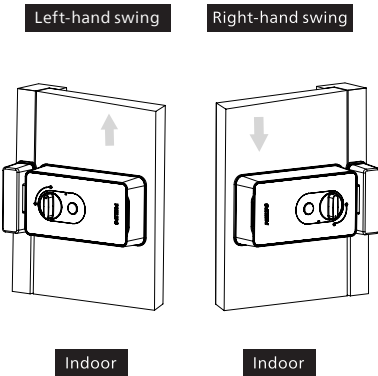

## Step 3 | Drill holes accordingly with the correct drilling template

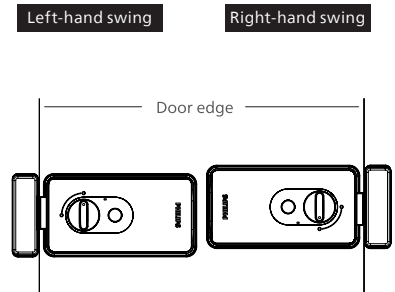

## Assembly procedures

The following assembly instructions are for right-hand swing doors. For left-hand swing doors, please invert the interior assembly for installation. Use the appropriate installation method for the strike plate according to the actual door swing direction.

- ① Pass the front assembly cable through the door hole.

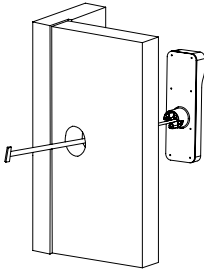

- ② Secure the mounting plate with screws.

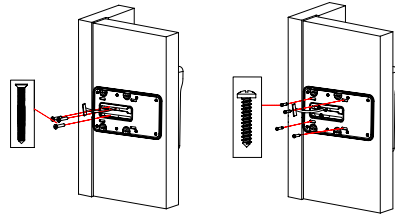

**Attention**

Be careful not to break the assembly cable.

- ③ Insert the connecting cable of the exterior assembly into the interior assembly.

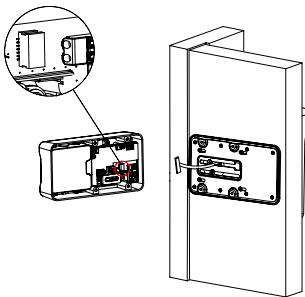

- ④ Install the interior assembly and secure it with screws.

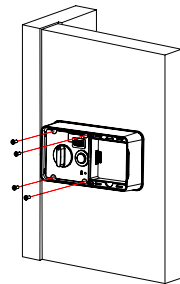

- ⑤ Based on the lock's assembly height, select the appropriate strike shim and attach them to the strike after assembling the strike, secure the strike cover with the screws.

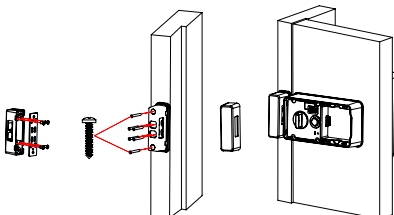

- ⑥ Insert the battery pack and fasten the battery cover.

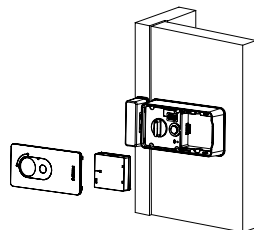

# 3 Get to know your lock

## Exterior assembly

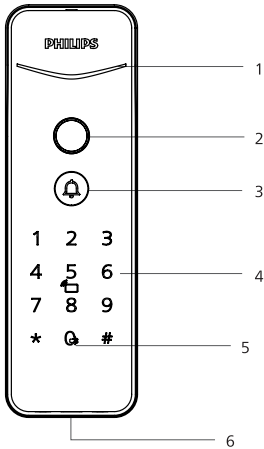

①	Lock Status Indicator
②	Fingerprint sensor
③	Doorbell
④	Keypad
⑤	Mute button
⑥	Reboot and emergency charging port

## Interior assembly

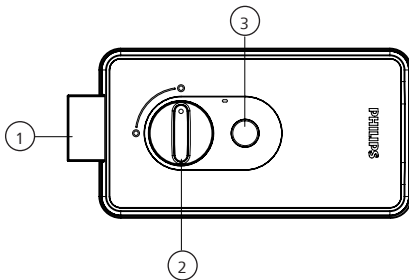

①	Dead bolt
②	Thumb turn
③	Functional button

# 4 Settings

## Instructions before setting

◆ The system mode is divided into general mode and dual-verification mode.

---

General mode                      Any enrolled access method can unlock the door.

---

Dual-verification mode        Unlocked the door with both enrolled fingerprint and PIN code.

---

### ◆ User number

You can delete individual users by their user numbers in the system without deleting all of them. You may use the table below to keep track of user information for management and reference.

User number	Name	Fingerprint	PIN code
00			
01			
02			
03			
04			
05			
06			
07			
08			
09			

### ◆ Icon annotation

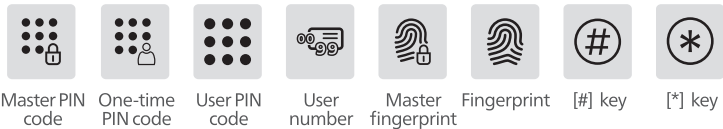

### ⚠ Attention

1. Press [\*] to return to the previous menu.
2. The default initial PIN code is 12345678.

## Master mode

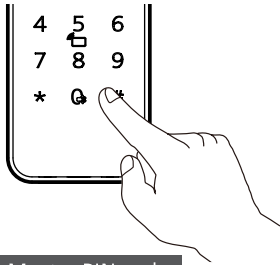

### Master PIN code

After illuminating the keypad, without inputting any other numbers, press the [\*] key twice, then enter the master PIN code, and press [#] to confirm to enter master mode.

#### Attention

If the master PIN code is set to the default PIN code, you must navigate to [1] and then [5] in master mode to change the master PIN code before proceeding with other operations.

### Master fingerprint

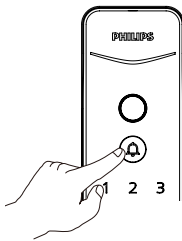

After illuminating the keypad, without entering any other numbers, press the [\*] key twice. Then, place the enrolled finger on the fingerprint sensor to enter master mode.

#### Attention

1. The door lock is initially without a master fingerprint. Please enroll a master fingerprint before use.
2. Do not enroll the master fingerprint as the same as user fingerprint.

## Settings

### Add a user PIN code



Press the [\*] key twice, enter the master PIN code, and then press the [#] key to confirm.



Press [1] to enter settings, then press [1] again to add a user. The door lock will automatically detect and add PIN codes, fingerprints, and key tags. Users can simply add the desired access method.

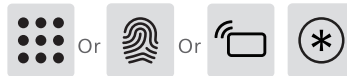

Add a PIN code: Enter a new user PIN code, press [#] to confirm, then re-enter the PIN code and press [#] again. After the successful addition prompt, press [\*] to return to the previous menu until exiting master mode.

Add a fingerprint: Place your finger on the fingerprint sensor. When prompted to "Please remove your finger and try again," lift and then re-place your finger on the sensor. Repeat this process several times.

After hearing the successful addition prompt, press the [\*] key to return to the previous menu until exiting master mode.

Add a key tag: Enroll a new key tag. After the successful addition prompt, press the [\*] key to return to the previous menu until exiting master mode.

### Modify or add a master fingerprint



Press the [\*] key twice, enter the master PIN code, and then press the [#] key to confirm.



Press [1] to enter settings, then press [4] to enter the option for adding or modifying the master fingerprint.



**No master fingerprint set:** Input a new user fingerprint, which will automatically become the master fingerprint. After hearing the successful addition prompt, press the [\*] key to return to the previous menu until exiting master mode.

**Master fingerprint already set:** Input a new user fingerprint, which will replace the existing master fingerprint. After hearing the successful addition prompt, press the [\*] key to return to the previous menu until exiting master mode.

### Modify a master PIN code



Press the [\*] key twice, enter the master PIN code, and then press the [#] key to confirm.



Press [1] to enter settings, then press [4] to modify the master PIN code.



Enter a new master PIN code, press [#] to confirm, then re-enter the PIN code, and press [#] to confirm. After the successful setting prompt, press the [\*] key to return to the previous menu until exiting master mode.

### Delete a user



Press the [\*] key twice, enter the master PIN code, and then press the [#] key to confirm.



Press [1] to enter settings, then press [6] to delete a user.



Choose the access method to delete: Press [1] to delete a PIN code; Press [2] to delete a fingerprint; Press [3] to delete a key tag. Follow the voice prompts for specific deletion instructions. After successfully deleting, press the [\*] key to return to the previous menu until exiting master mode.

## Network settings

### Download

Scan the QR code below or search for 'Home Access' in the app store to download and install.



### Add a door lock

1. Install batteries and power up the door lock.
2. Turn on Bluetooth on your phone, open the app, tap 'Add a device' on the homepage, and follow the prompts in the app to complete the network binding.

# 5 Get to use your lock

## Outdoor/ indoor unlock

### Outdoor unlock

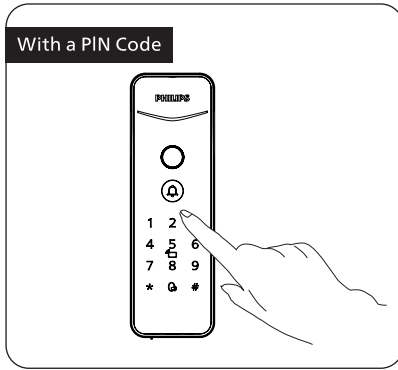

**Step1:** Touch to light up the keypad. Enter the pre-enrolled PIN code, then press [#] key to confirm.

**Step2:** After hearing the voice prompt "Door opened", push down the handle to open the door.

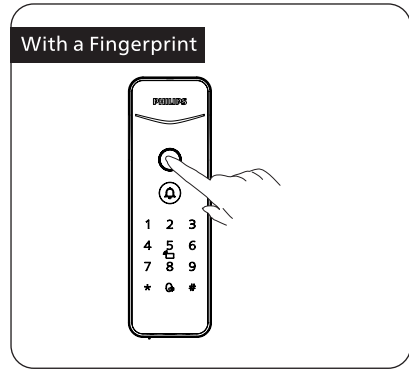

**Step1:** Place the pre-enrolled finger on the fingerprint sensor.

**Step2:** After hearing the voice prompt "Door opened", push down the handle to open the door.

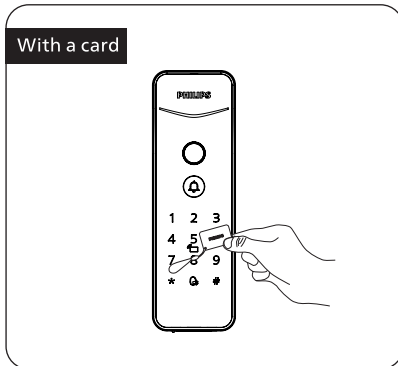

**Step1:** Place the pre-enrolled key tag on the card recognition area.

**Step2:** After hearing the voice prompt "Door opened", push down the handle to open the door.

## Indoor unlock

### Thumb turn

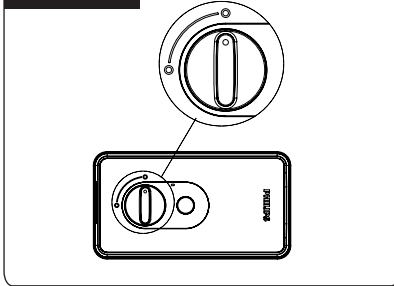

Turn the thumb turn to the green mark (as shown in the picture) to unlock.

### Functional button

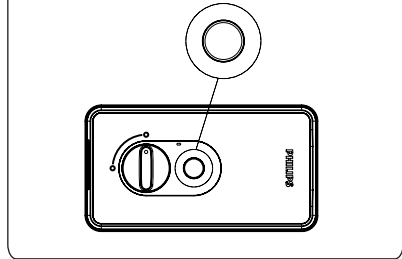

Press [functional button] twice to unlock the door.

## 6 Other features

---

### Default settings

---

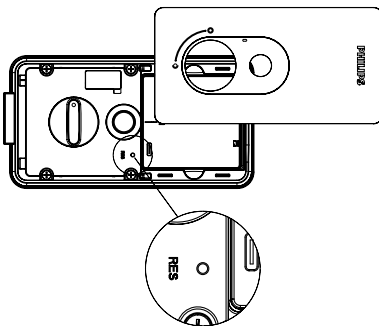

#### Function:

To empty all user information and restore to default settings.

#### How to use:

Press the [RES] button twice, all user information will be erased and the lock will be restored to its default settings.

#### ⚠ Attention

After restoring the factory settings, all information in the door lock system will be cleared. Please proceed with caution.

## Mute button

---

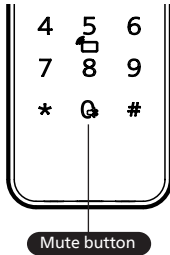

### Function:

Activate mute mode by pressing the mute button to silence voice prompts during door unlock—great for quiet times to avoid disturbing others in the household.

### How to use:

1. Switching voice mode to mute mode: while the system is awake, press and hold the "Mute" button for 2 seconds to enter mute mode. The voice prompt will say "Mute mode". information will be erased and the lock will be restored to its default settings.
2. Switching mute mode to voice mode: while the system is awake, press and hold the "Mute" button for 2 seconds to return to voice mode. The voice prompt will say "Voice mode".

## Armed mode

---

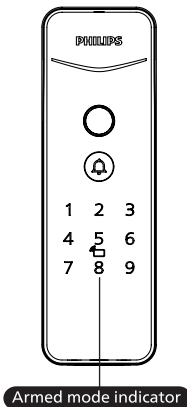

**Function:** Once the door lock is opened from the inside, the alarm will be triggered.

**How to use:** After successfully locking the door, press[8]to enter the Armed mode.

### ⚠ Attention

The Armed mode will not affect normal opening from the outside.

# 7 Indicators

---

## Armed mode indicator

---

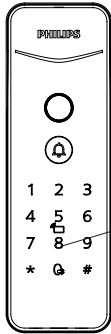

### Meanings of the indicator in different colors

**White:** When the lock is in a locked state, the number "8" key will light up independently in white to indicate that the armed mode can be enabled.

## System-locking indicator

---

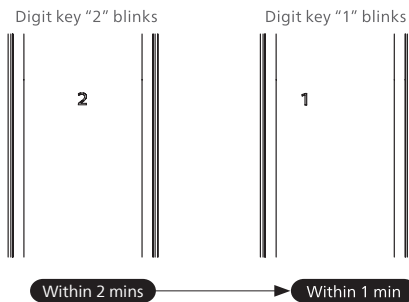

The door lock will be locked for 100 seconds if there are 5 consecutive incorrect attempts of any enrolled access method (i.e. fingerprint, PIN code, and key tag) in 5 minutes.

### ⚠ Attention

The prompt will only appear when the touchscreen is lighting up or any of the access methods is being verified.

# 8 Troubleshooting

---

## Alert types

### Armed mode alert

---

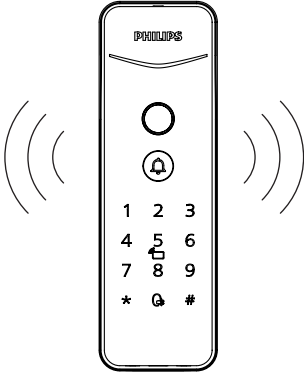

**Triggering:**

When the door lock is in the armed mode, opening the door lock from the inside will trigger an alert.

**Alert mode:**

Continuous and repeated alarm sound.

**Off:** The alarm will be stopped when any of the enrolled access methods is successfully verified.

---

### Low battery alert

---

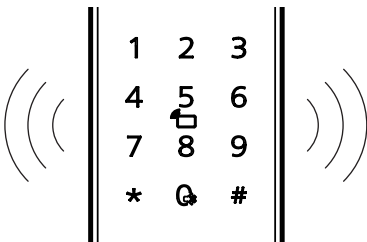

**Triggering:** After the system wakes up, it will detect the battery voltage automatically. If the voltage is low, an alarm will sound to notify you to replace the battery promptly.

**Alert mode:** With a voice prompt of low battery, please replace the batteries in time.

**Off:** Turn off automatically.

## How to apply an external power supply

---

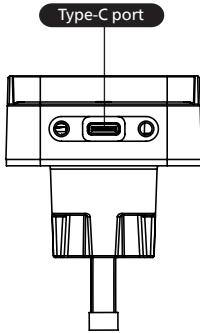

If the battery voltage is too low to open the lock from the outside, you can use a 5V power bank as an external power supply by connecting it to the lock through the Type-C port. Once you have unlocked the door, please replace the battery immediately.

## Battery replacement

---

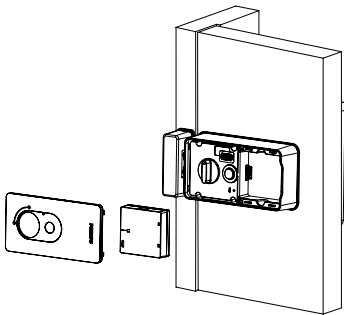

The working power of the door lock is 4pcs AA alkaline batteries. The battery compartment is located on the upper end of the interior assembly. To remove the battery, you can remove the battery cover and take out the battery.





Philips and the Philips Shield Emblem are registered trademarks of Koninklijke Philips N.V. and are used under license. This product has been manufactured by and is sold under the responsibility of Shenzhen Conex Intelligent Technology Co., Ltd., and Shenzhen Conex Intelligent Technology Co., Ltd. is the warrantor concerning this product.